

INSTRUCTION

Installation instructions

FEELUX Appliance Control (Phase to PWM Translator)

Type **FDB-PIH**

Input Rating	120VAC 60Hz 5A	Output Rating	Max. 600W
Input Signal	120VAC 60Hz	Output Signal	PWM, Max.10pcs per row line
Lighting Load	DIMSLIM or DIMSLIMLINE		



Mounting dimensions

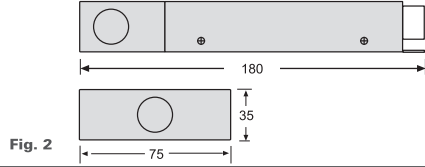
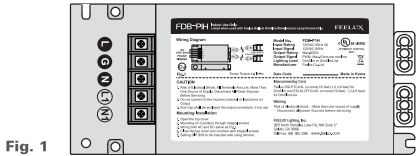

Fig. 1

Fig. 2

Mounting Arrangements

- Open the cover with proper tool.
For the lamp connection, please use Feelux bus wires for DimSlim/DimSlimLine only
- Following the wiring diagram, please connect the lighting fixtures to Input/Output terminals.
Please make sure that connection to Input/Output has to be not changed.
- Assemble the cover after arranging wires in the middle. Turn on the power.
Please make sure that the wires have to be not pressed at the end of sides of the cover.
- Set the decoder by controlling light intensity from the lowest stage to the highest 2-3times repeatedly.
Please make sure to use with general dimmers below minimum 60W.

Warning information

This product is for indoor use only. Fitting and removal must take place only with the supply disconnected. **Permanent mains connection must be undertaken only by a qualified specialist.** Always fully insert connections ! Pay attention to the marking (arrows) on the components.

Meaning of crossed-out wheeled dustbin: Do not dispose of electrical appliances as unsorted municipal waste, use separate collection facilities. Contact your local government for information regarding the collection systems available. If electrical appliances are disposed of in landfills or dumps, hazardous substances can leak into the groundwater and get into the foodchain, damaging your health and well-being. When replacing old appliances with new ones, the retailer is legally obligated to take back your old appliance for disposal at least free of charge.

Installation

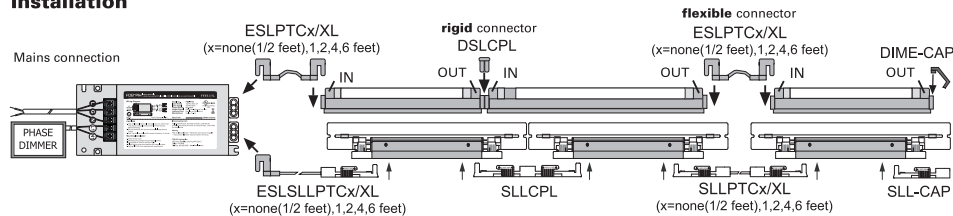

Maximum 10 pcs per channel and Maximum 600W irrespective of channel
Please use Feelux booster(FBB-P2P) for an additional line

The direction of the supply must be observed prior to installation (IN OUT). Fixing of the luminaires takes place via mounting clips. These must be fixed at the required point with a wood screw and the luminaire can be snapped in place. Impress the cover carefully at OUT at the last luminaire of a lighting row and fix it.

INSTRUCTION

Installation instructions

FEELUX Appliance Control (Phase to PWM Translator)

Type **FDB-PIH**

Input Rating	120VAC 60Hz 5A	Output Rating	Max. 600W
Input Signal	120VAC 60Hz	Output Signal	PWM, Max.10pcs per row line
Lighting Load	DIMSLIM or DIMSLIMLINE		



Wiring Diagram with Dimmer

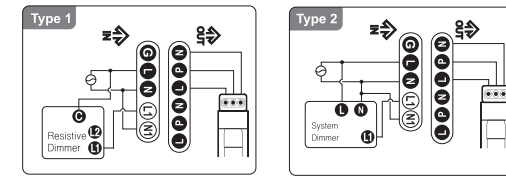

For Resistive Dimmer

For System Dimmer

CAUTION

- High Voltage-Disconnect power supply before servicing
- Do not connect to the incorrect channel of Input/(and or) Output
- End cap shall be enclosed the output connectors, If not use
- Interconnection Cord : Feelux ESLPTC/XL (x=none(1/2 feet),1,2,4,6 feet) for DimSlim and ESLSLLPTC/XL (x=none(1/2 feet),1,2,4,6 feet) for DimSlimLine

WARNING

Risk of electrical shock - More than one source of supply - Disconnect all power Sources before servicing
Do not use one line electronic dimmer
Indoor Use Only
Listed when used with Feelux Ballast DimSlim/DimSlimLine Lamp Fixture Only

One-year warranty, with one-to-one free replacement after inspection.
(excluding breakage due to transportation & mis-handling)

WARNING INFORMATION:

Meaning of crossed-out wheeled dustbin: Do not dispose of electrical appliances as unsorted municipal waste, use separate collection facilities. Contact your local government for information regarding the collection systems available. If electrical appliances are disposed of in landfills or dumps, hazardous substances can leak into the groundwater and get into the foodchain, damaging your health and well-being. When replacing old appliances with new ones, the retailer is legally obligated to take back your old appliance for disposal at least free of charge.