

Installation instructions

FEELUX Surface mounted LED Luminaire

Type SlimLamp Seamless LED AC 100-130V~, 50/60Hz

| | | |
|--------------|-----|--------|
| LDSLL10 -UNV | 10W | 0.085A |
| LDSLL15 -UNV | 15W | 0.150A |
| LDSLL20 -UNV | 20W | 0.200A |

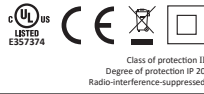

Mounting Dimensions

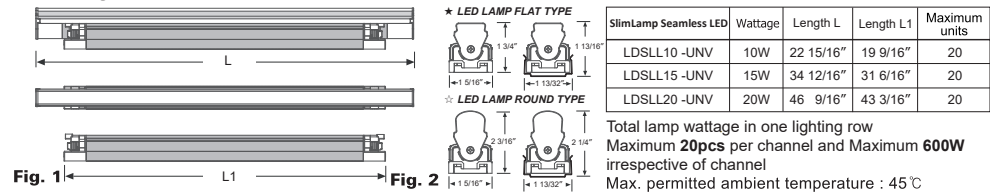

Mounting Arrangements

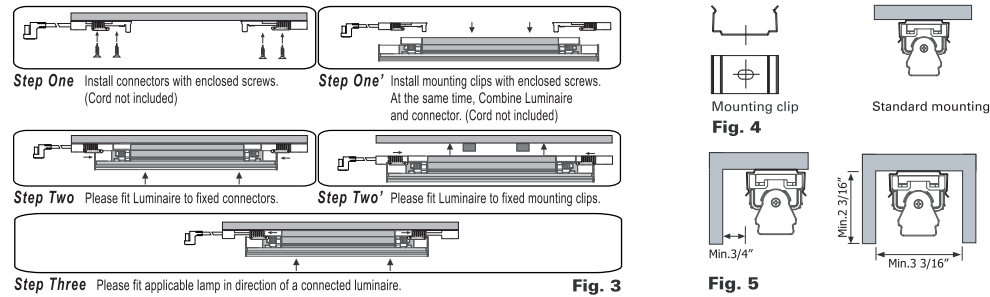

Lamp Replacement

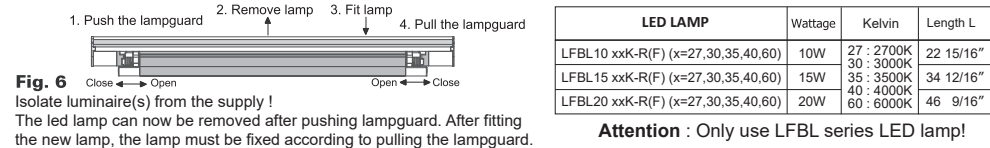

Installer Instructions for Hardwirebox

- Step1. Select one of the 1/2" Knockouts that will be used for wiring the box and snap it out with a flat head screwdriver
- Step2. Remove the three screws from the top of the box and over the top off. Select an appropriate bushing for the type of 1/2" trade conduit or wiring that will be used. Install the bushing in the knockout selected.
- Step3. Mount the box with appropriate screws or fasteners to the mounting surface using the four counter sunk holes in the bottom.
- Step4. Replace the box top and secure with the three screws. Connect the conduit to bushing if conduit was used.
- Step5. Connect the first SlimLamp Seamless LED luminaire to the connector on the box with one of the interconnecting cords.

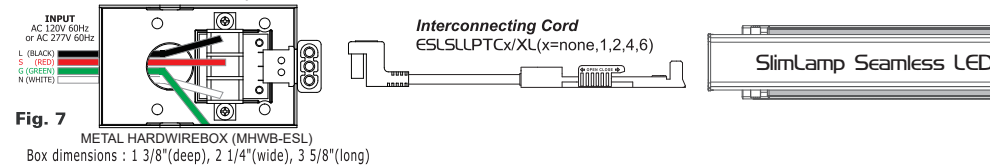

Interconnection Instructions

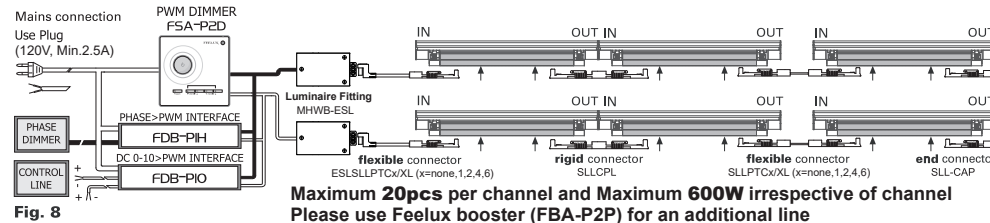

PLEASE CALL TOLL FREE 800-983-3346 for assistance if needed
No part of this publication may be reproduced without the prior permission of the publishers.

FEELUX U.S.A. Office : 3000 Northwoods Parkway, Suite 115 Norcross, GA 30071 U.S.A (www.feelux.com)

Installation instructions

FEELUX Surface mounted LED Luminaire

Type SlimLamp Seamless LED AC 220-240V~, 50/60Hz

| | | |
|--------------|-----|--------|
| LDSLL10 -UNV | 10W | 0.055A |
| LDSLL15 -UNV | 15W | 0.075A |
| LDSLL20 -UNV | 20W | 0.100A |

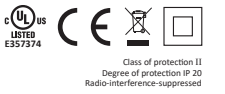

Dimmable lighting system for exhibitions and shop-fittings and as lighting row luminaire with through-wiring and integral plug connectors.

Mounting Dimensions

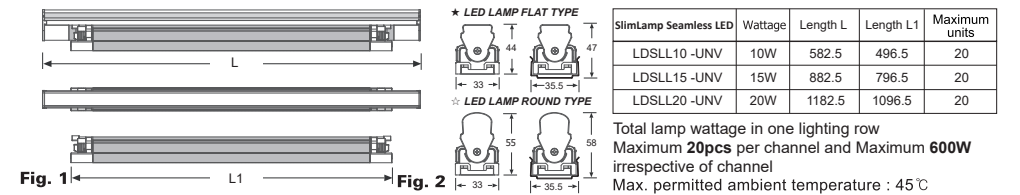

Mounting Arrangements

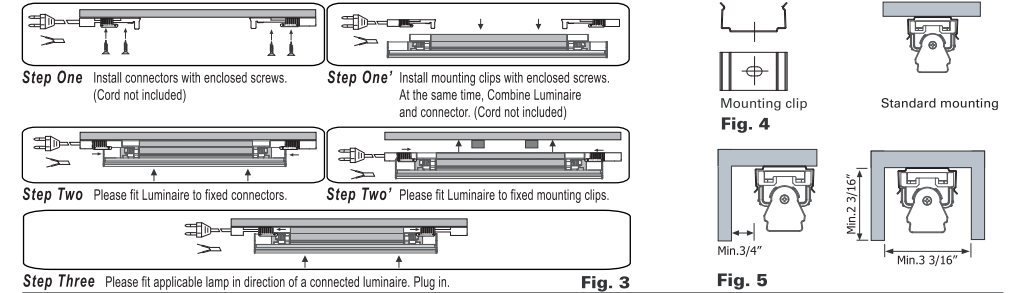

Warning information:

- This product is for indoor use only. Fitting and removal must take place only with the supply disconnected. **Permanent mains connection must be undertaken only by a qualified specialist.** Always fully insert connections ! Pay attention to the marking (arrows) on the components.
- Meaning of crossed-out wheeled dustbin: Do not dispose of electrical appliances as unsorted municipal waste, use separate collection facilities.
- Contact your local government for information regarding the collection systems available.
- If electrical appliances are disposed of in landfills or cumps, hazardous substances can leak into the groundwater and get into the foodchain, damaging your health and well-being.
- When replacing old appliances with new ones, the retailer is legally obligated to take back your old appliance for disposal at least free of charge.

Attention: The connection and the dimming of the SlimLamp Seamless LED is possible with FEELUX Dimming Controller FSA-P2D or DAO2VIOSE exclusively. No warranty will be given when used with any dimmer or dimmer switch other than supplied and authorized by FEELUX

CAUTION (ATTENTION)

- MIN 90 °C SUPPLY CONDUCTORS (LES FILS D'ALIMENTATION 90 °C MIN)
- SUITABLE FOR DAMP LOCATIONS ONLY (SUITABLE POUR LES LOCATIONS DAMP SEULEMENT)
- SUITABLE FOR OPERATION IN AMBIENT NOT EXCEEDING 45 °C (PEUT ÊTRE UTILISÉ À UNE TEMPÉRATURE AMBIANTE N'EXCÉDANT PAS 45 °C)
- RISK OF SHOCK - DISCONNECT POWER BEFORE SERVICING (RISQUE DE CHOC - COUPER L'ALIMENTATION AVANT L'ENTRETIEN)
- SUITABLE FOR CONTINUOUS ROW MOUNTING (PEUT ÊTRE MONTÉ EN RANGÉE CONTINUE)
- SUITABLE FOR UNDER-CABINET MOUNT (PEUT ÊTRE FIXÉ SOUS UNE ARMOIRE)

Installation

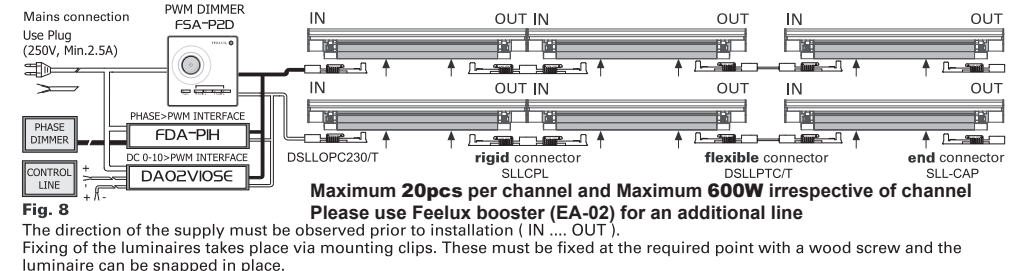

No part of this publication may be reproduced without the prior permission of the publishers.
Nachdruck auch auszugsweise verboten.

FEELUX Head Office : 624-8, Seogu-i, Gwangjeok-myeon, Yangju-si, Gyeonggi-do, Korea (www.feelux.com)