

# FLX Spot DVP

: LED for display, showcase, ceiling, wall

Versatile Mini LED Spotlight

FEELUX

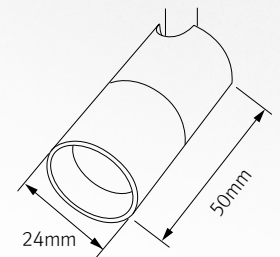

Swivel Mini LED Spotlight

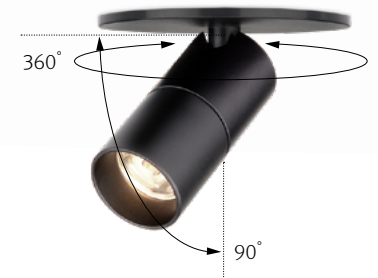

Round Plate

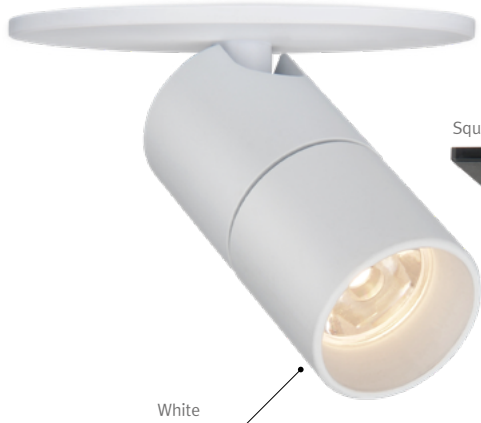

White

Square Plate



Black

Special Order Options



Silver

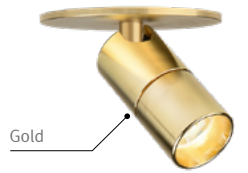

Gold

DIVA Point : **FLX Spot DVP**



- To be used with constant voltage DC 24V driver
- Mini spotlight with various beam angle
- Dimmable with available accessories
- Available in black and white

Model Name	DVP3 40K-24V-BK-28-RP
Finish	Black, White, Silver, Gold
Power Input	DC 24V
Lamp Power	2.6 W
Lumens	253.1 lm
Efficiency	97.7 lm/W
Color Rendering	Ra > 90
Available Color	2,700K/3,000K/3,500K/4,000K
Beam Angle	28° / 40° / 50°
Operating Temperature	0 ~ 45°C

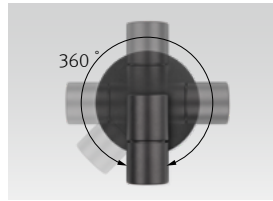
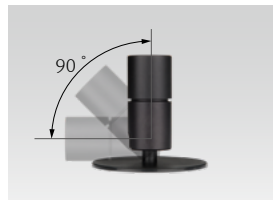

송강 정철-사미인곡



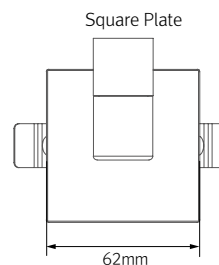
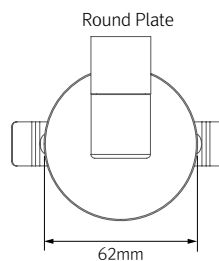
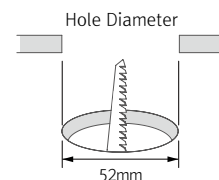
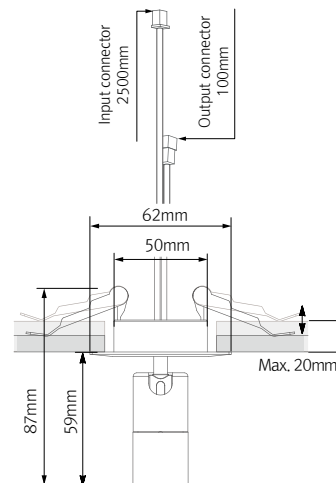

★ Linkabel between FLX Spot DVP and FLX Sopt DVP (Max.10 units connectable)

**Ⓐ FLX Spot DVP**

	RP(Round Plate)	SP(Square Plate)
BK	28° DVP 40K-24V-BK-28-RP	DVP 40K-24V-BK-28-SP
	40° DVP 40K-24V-BK-40-RP	DVP 40K-24V-BK-40-SP
	50° DVP 40K-24V-BK-50-RP	DVP 40K-24V-BK-50-SP
WT	28° DVP 40K-24V-WT-28-RP	DVP 40K-24V-WT-28-SP
	40° DVP 40K-24V-WT-40-RP	DVP 40K-24V-WT-40-SP
	50° DVP 40K-24V-WT-50-RP	DVP 40K-24V-WT-50-SP

**Ⓑ LED Driver with 12way distributor, with power cord (1,800mm)**

Part No	FLC30-24V/T	FLC75-24V-P/T	FLC200-24V-P/T
Capacity	30W 24V	75W 24V	200W 24V
Max connection	10	25	66

**Ⓒ 12 Port Hub**

D12P-HUB:  
Included with Cord and Plug drivers. Order separately for Hard Wire or 3rd Party Drivers

**Ⓓ Dimming Interface (1-10V) : FDC-L10**

Max. 100W (100W/CH, 1CH)

**Ⓔ Dimming Interface (0-10/1-10,DMX512)**

FDA-L2M0 : Max. 200W (100W/CH, 2CH)  
FDA-L5M : Max. 200W (50W/CH, 5CH)

**Ⓚ Dimming Interface (Dail) : FDD-L1DA**

Max. 200W (100W/CH, 1CH)

**Ⓛ Dimming Interface (Zigbee) : \_FDD-L2Z, \_FSM-Z1(switch)**

Max. 200W (100W/CH)

**Ⓜ Door and motion detection sensor (DC) : FLS-M24V**

Voltage : DC 24V

**Ⓨ Human-body detection sensor (DC) : FLS-P24V**

Voltage : DC 24V

**Ⓩ DVP HOOD**

DVP3-HOOD-BK-28  
Hood with lens for replacement

