

# SlimLamp (Three Wire)

T5 Three-wire grounded linear Illumination



## SlimLamp

SlimLamp standard T5 with three wire grounded connector. SlimLamp is highly efficient with a built-in electronic ballast and low heat output. Its modular connecting systems and interchangeable lengths allows the SlimLamp to create a long and continuous flow of fluorescent light for any tight space.

Easy connection



## Product Features

- 3-wire grounded
- High efficiency built-in rapid start ballast
- End of Lamp life (EOL) protection
- Low profile rigid extruded aluminum body
- Quick connection system
- Daisy chain up to 600W together

## Benefits

- Low heat output makes it ideal for use in display
- Fits almost anywhere
- Installation savings through quick connection system
- Operates in very tight areas

## Application

- Space for Modern design by using T5 size (16mm)
- Office, Hotel, Living room, Cabinet, Showcase, Furniture

## Specification

- Frequency range : 60Hz
- Voltage : 110~130V
- Power factor : >97%
- Color rendering : Ra>80
- Tube life: 20,000hr
- Tube diameter: 16mm(T5)
- Class of protection II
- Degree of protection IP20
- Supply Voltage : 120V
- Line frequency : 60Hz
- Automatic safety shutdown of lamps in the event of a defect or at end of life (EOL)
- Automatic restart after lamp replacement
- Approval marks : cULus mark
- Safety acc. to UL 153 and C22.2 NO.12

## Installation

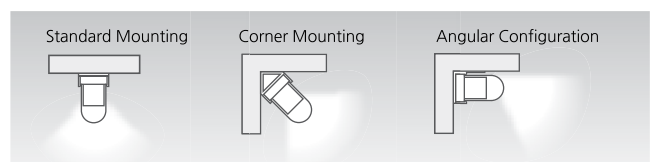



**Notice**

Maximum interconnected wattage (units) : 600W  
 14W(38pcs), 21W(26pcs), 28W(21pcs)

**Accessories**

Ⓐ Connecting cables

ESLPTC/XL	ESLPTC1/XL	ESLPTC2/XL	ESLPTC4/XL	ESLPTC6/XL
6inch(150mm)	1feet(300mm)	2feet(600mm)	4feet(1200mm)	6feet(1800mm)

Ⓑ Direct connector : ESLCPL

Ⓒ Metal hard wire box : MHWB-ESL

Ⓓ Power cord : ESLPC120/XL

Ⓔ Fluorescent lamps

2200K, 2700K, 3000K, 3500K, 4000K, 6500K, 8000K,  
 Red, Green and Blue are available.

Ⓜ Matal Bracket : MSL BRACKET

Ⓝ Diffuser

ESL14CV	ESL21CV	ESL28CV
14W	21W	28W

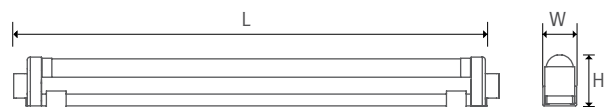
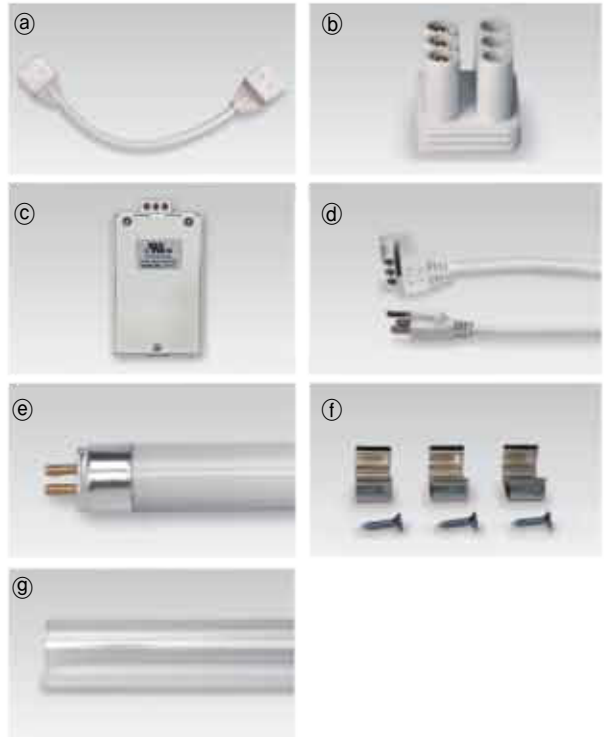

Model Name	LampPower (W)	L (inch)	W (inch)	H (inch)	H (inch) with diffuser
ESL14-120V	14	23 7/16	31/32	1 5/8	1 3/4
ESL21-120V	21	35 4/16	31/32	1 5/8	1 3/4
ESL28-120V	28	47 1/16	31/32	1 5/8	1 3/4